



## Meadowvale

For Sale

\$130,000 - \$145,000

🛏 1 🚿 1

Wattletree Floorplan | 12-26 Eagle Drive - Pakenham - VIC

📏 36.5 m<sup>2</sup> Floor Area

### Serviced Apartment | Wattletree Floorplan

The Wattletree floorplan at Meadowvale is a one bedroom and one bathroom floorplan, offering a spacious living room. The size of the apartments are at a comfortable 36.5 square metres. All the Wattletree apartments enjoy a fully equipped kitchenette, all containing a small fridge. Furthermore, the spacious bedroom makes you feel right at home. The apartment has air conditioning and heating. Depending on the home you choose (ground level or upper), the Wattletree floorplan offers a lovely patio (ground level), so you have the magnificent views over the lovely, manicured gardens of Meadowvale and/or the other beautiful natural scenery within the village grounds.



1800 550 550  
keyton.com.au

\*Photographs are for illustrative purposes. Some images may depict items not provided by Keyton within the units such as furniture and other decorative items.

Wattletree Floorplan | 12-26 Eagle Drive - Pakenham - VIC

 1  1

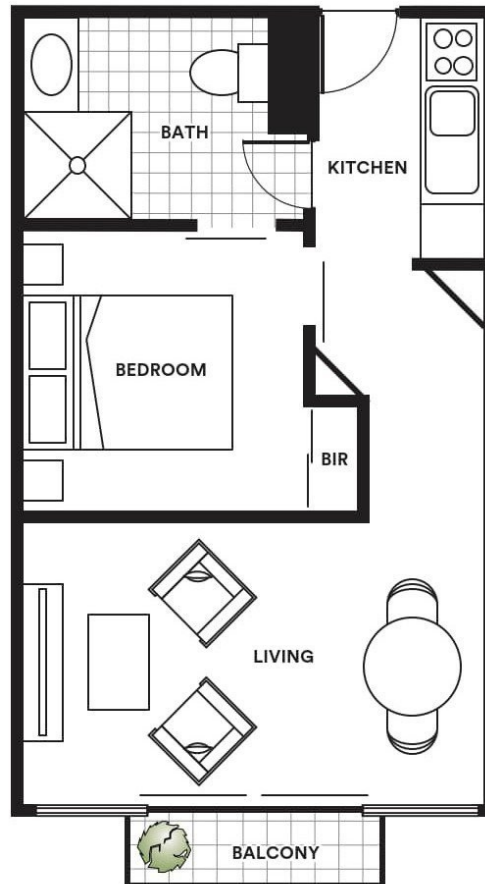

Area	m <sup>2</sup>
Total	36.5

This is an indicative floor plan that may vary according to home location within the village/resort. The information, dimensions and specifications on this floor plan are believed to be correct but is not guaranteed and may change without notice. Any illustrations are an artist's impression only and subject to change. Keyton gives no warranty concerning the accuracy of the material or information displayed in this brochure and all such warranties (whether implied or otherwise) are excluded to the extent permitted by law. Prospective purchasers should make their own enquiries.